



MON SHEONG COURT

Markham Buttonville
萬錦百頓孟嘗閣

Standard Color Selection & Optional Upgrades

Suite No. _____ Date: _____

Purchaser
Name(s) _____
Signature(s) _____

Markham Buttonville Mon Sheong Court

LL1

Authorized Signature

Terms and conditions:

1. After the completion and submission of the Colour Selection & Optional Upgrades there will be no further changes, revisions, deletions and upgrades allowed, except for discontinued items that must be re-selected or where the Vendor has given its written consent at its sole discretion. Purchaser acknowledges that the Vendor accepts no responsibility in the event the Vendor is unable to supply a selection. In such case the Purchaser agrees to reselect from the then available selections immediately upon request.
2. The Purchasers acknowledge and accept that they shall not be entitled to any credit whatsoever for any changes and/or upgraded finishes that are included in the Agreement of Purchase and Sale should they elect to alter, replace or delete any of the above finishes.
3. All items herein requested shall be from the Vendor's standard samples unless otherwise noted. Variations from the Vendor's samples may occur in finished materials due to normal production processes, dye lot variations and/or natural variations.
4. The Purchaser acknowledges that all selections are subject to the terms and conditions of the Agreement of Purchase and sale.

Package A

- Gold Gloss Silver
Matte Silver Black Initial: _____



British Timber
米白木紋

Package B

- Gold Gloss Silver
Matte Silver Black Initial: _____



Arctic Ice
高光白

Package C

- Gold
- Matte Silver
- Gloss Silver
- Black
- Initial: _____



Maple Ridge
太妃木紋

Package D

- Gold
- Matte Silver
- Gloss Silver
- Black
- Initial: _____



English Oak
天然木紋

Optional - Pot Lights Package

(price includes installation, taxes excluded)

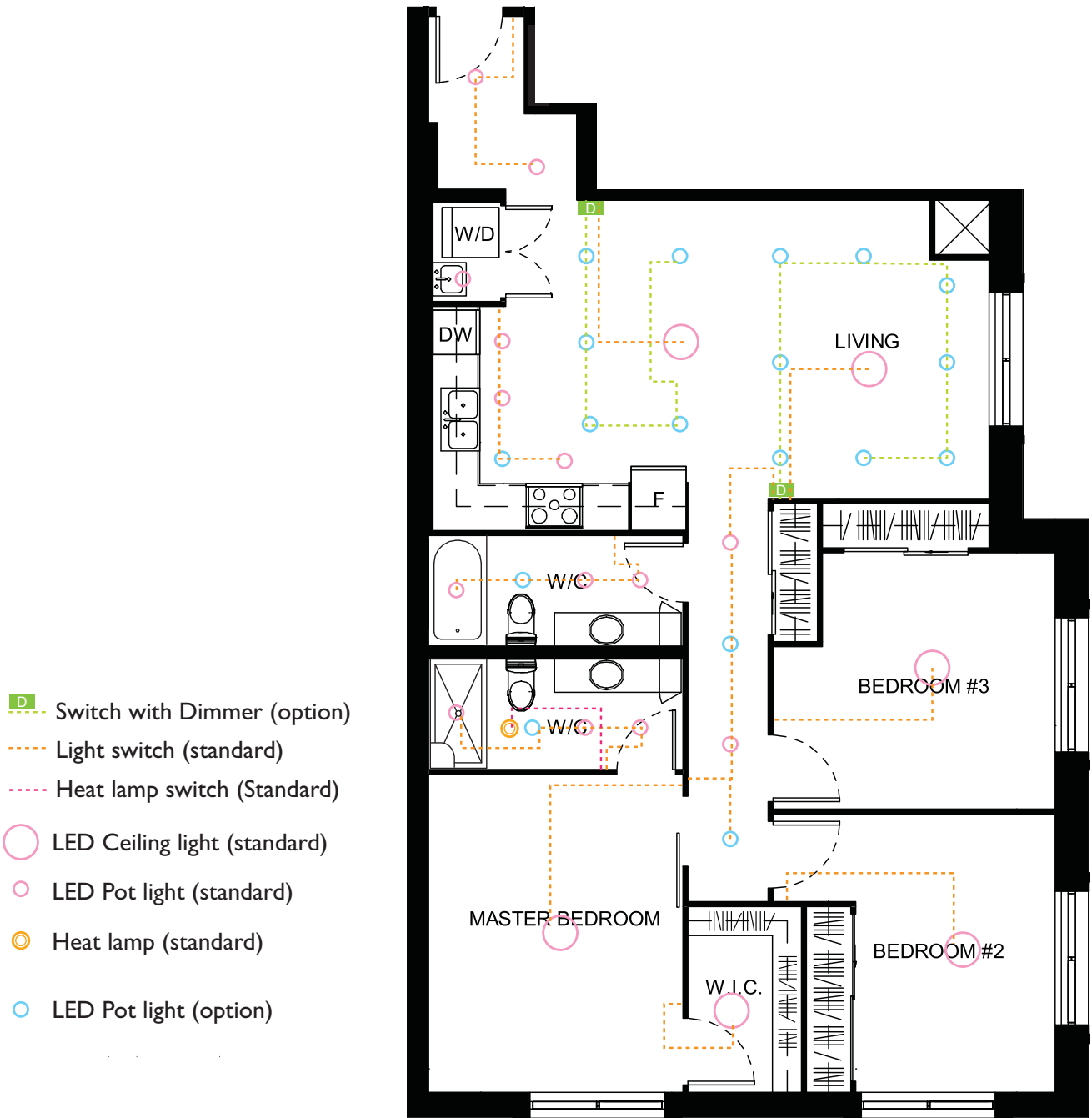

- D Switch with Dimmer (option)
- Light switch (standard)
- Heat lamp switch (Standard)
- LED Ceiling light (standard)
- LED Pot light (standard)
- Heat lamp (standard)
- LED Pot light (option)

Initial: _____

Optional -Murphy Bed & Wall Cabinet

(price includes installation, taxes excluded)



A. Closet Cabinet

C. Display Cabinet

B. Murphy Bed

D. Bookcase Cabinet

Initial: _____

Optional Items Order Sheet

(price includes installation, taxes excluded)

	ITEM	PER UNIT	QUANTITY	PRICE
<input type="checkbox"/>	MURPHY BED & WALL CABINET UNIT			
				
	<input type="checkbox"/> A. Closet Cabinet	\$2,500		
	<input type="checkbox"/> B. Murphy Bed (Single) <i>Mattress excluded</i>	\$2,200		
	<input type="checkbox"/> Murphy Bed (Double) <i>Mattress excluded</i>	\$2,800		
	<input type="checkbox"/> C. Display Cabinet	\$2,000		
	<input type="checkbox"/> D. Bookcase Cabinet	\$ 800		
<input type="checkbox"/>	PULL-DOWN CABINET	\$1,500		
<input type="checkbox"/>	EV PARKING CHARGING PLUG (240W)	\$3,000		
<input type="checkbox"/>	Pot Lights Package			
	<i>1,280 sqft (3 bedroom) unit</i>	\$4,500		
	NOTES:			
	<small>Terms and conditions: 1. After the completion and submission of the Colour Selection and Optional Upgrades there will be no further changes, revisions, deletions and upgrades allowed, except for discontinued items that must be re-selected or where the Vendor has given its written consent at its sole discretion. Purchaser acknowledges that the Vendor accepts no responsibility in the event the Vendor is unable to supply a selection. In such case the Purchaser agrees to reselect from the then available selections immediately upon request. 2. The Purchasers acknowledge and accept that they shall not be entitled to any credit whatsoever for any changes and/or upgraded finishes that are included in the Agreement of Purchase and Sale should they elect to alter, replace or delete any of the above finishes. 3. All items herein requested shall be from the Vendor's standard samples unless otherwise noted. Variations from the Vendor's samples may occur in finished materials due to normal production processes, dye lot variations and/or natural variations. 4. The Purchaser acknowledges that all selections are subject to the terms and conditions of the Agreement of Purchase and sale.</small>			
	* Here to acknowledge payment for optional items are paid in full. All sales are final. <div style="display: flex; justify-content: space-between;"> <div style="width: 45%;"> Purchaser Signature: <input style="width: 90%;" type="text"/> Date: <input style="width: 90%;" type="text"/> </div> <div style="width: 45%;"> Markham Buttonville Mon Sheong Court: Date: <input style="width: 90%;" type="text"/> </div> </div>			SUBTOTAL
				HST
				TOTAL